

Service Data

Vickers® Vane Pumps



Single Vane Type Pump

20V-**A(F)-**-22-*



Service Data

Vane Type Single Pumps

20V-**A(F)-**-22-*

Model	● Outlet Plate S/A	● Rotor	● Vane Kit	● Inlet Plate	● Ring	● Cart Kit	● F3 Cart Kit
20V5	451453	402690	02-136720	584383	333624	02-102518	02-102523
20V8					333625	02-102519	02-102524
20V11		403539	02-136721	584384	333626	02-102520	02-102525
20V12					353901	02-102521	02-102526
20V14					353902	02-102522	02-102527

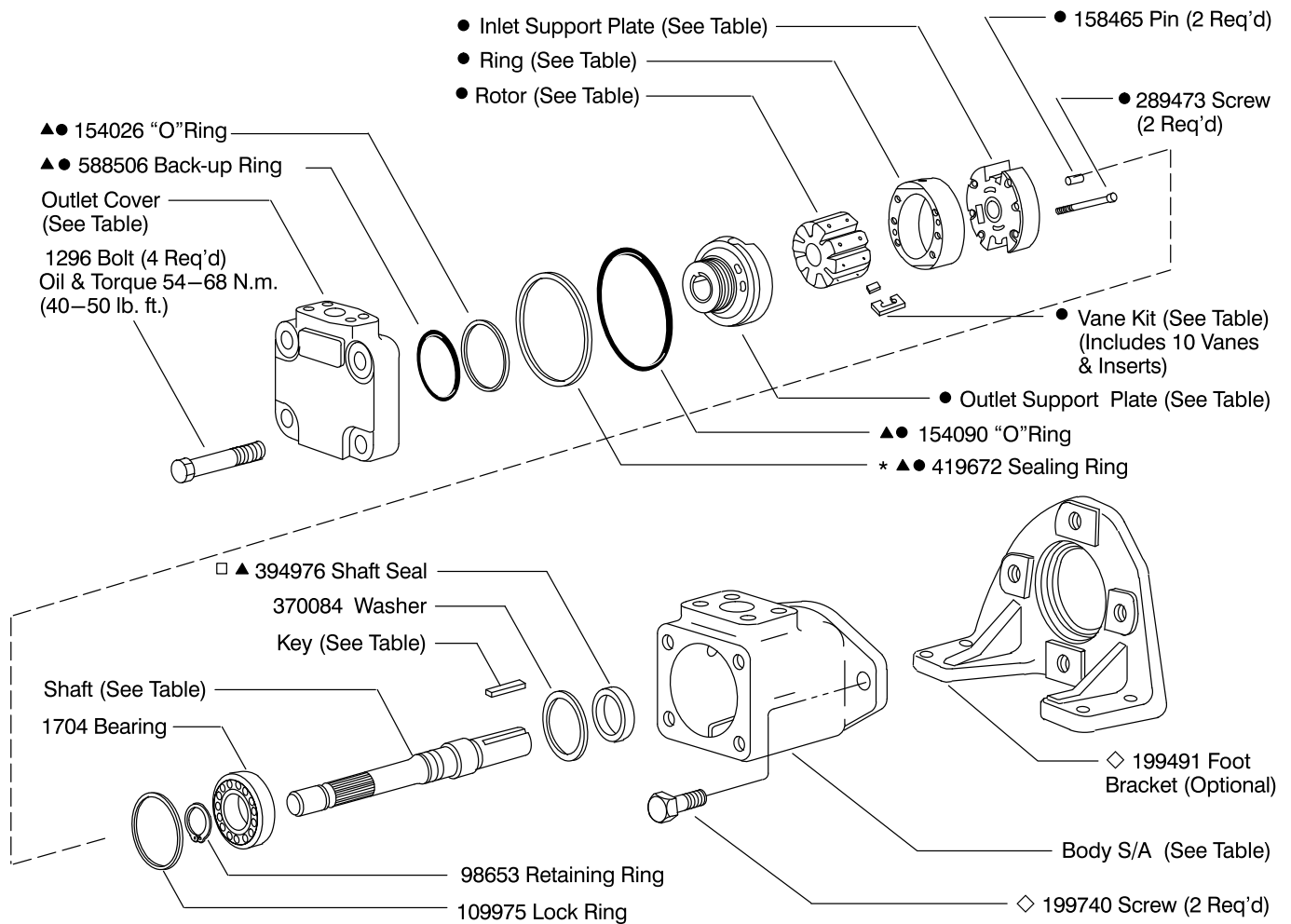

□ Assemble seal with spring loaded sealing member towards bearing. Seals to be completely wetted with oil prior to assembly.
 * Install 419672 sealing ring into body, Then install cartridge kit.

Shaft	Type	Key
497109	(1) keyed	9955
497113	(151) splined	

Model	Outlet Cover	Body S/A
20V**A	250824	02-102335
20V**C	252504	02-102335

- Included in cartridge kit
- ▲ Included in seal kit 497125
F3 equivalent seal kit 981322
- ◇ Included in foot bracket kit FB-B-10

Model Code

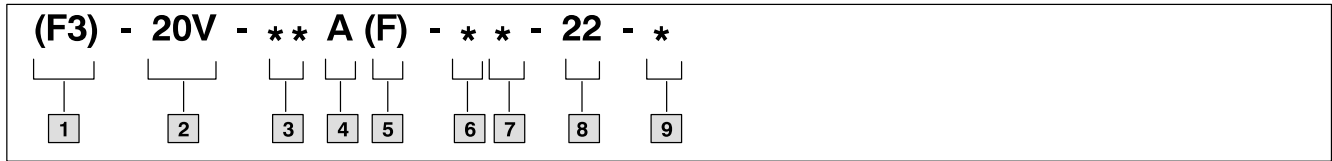

1 Special seals

2 Series designation

20V – 18 to 36 cm³/r
(1.1 to 2.2 in³/r)

3 Geometric displacement

(Rated capacity (USgpm) at 1200 rpm, 6.9 bar (100 psi))

Code	cm ³ /r	in ³ /r
5	18	1.10
8	27	1.67
11	36	2.22
12	40	2.47
14	45	2.78

4 Port connections

Code	Inlet	Outlet
A	4 bolt flg.	4 bolt flg.
C	4 bolt flg.	Str. thd.

5 Mounting

F – Foot mounting
Omit – Flange mounting

6 Shaft

1 – Straight keyed
151 – “B” Spline

7 Outlet positions

(Viewed from cover end of pump)

A – Opposite inlet port
B – 90° CCW from inlet
C – Inline with inlet
D – 90° CW from inlet

8 Design

9 Rotation

(Viewed from shaft end of pump)

L – Left hand for counterclockwise
R – Right hand for clockwise

NOTE

To reverse cartridge kit rotation, remove the two screws and reverse the location of the inlet support plate and outlet support plate. Re-install the two screws hand tight. Use pump cover to align all sections of the cartridge. Carefully remove the cover and tighten the screws.

NOTE

When ordering spare cartridge parts, it is recommended they be obtained in cartridge kits. Kits are assembled and tested by Vickers for either right or left hand rotation. If left hand rotation is required, it should be specified on parts order by adding suffix “L” to cartridge kit number.

NOTE

For satisfactory service life of these components in industrial applications, use full flow filtration to provide fluid which meets ISO cleanliness code 16/13 or cleaner. OFP, OFR, and OFRS series filters are recommended.

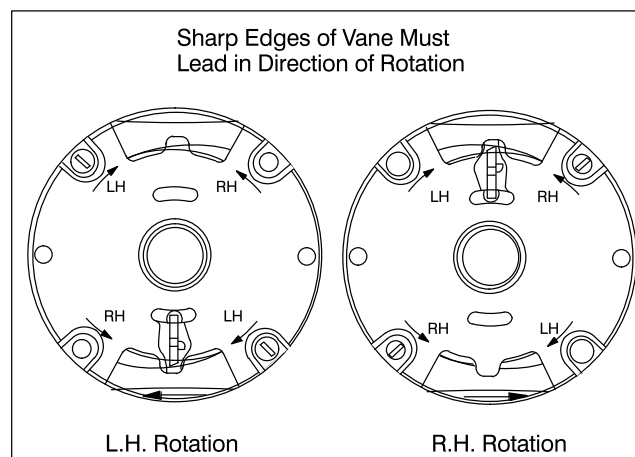

Eaton Hydraulics

15151 Highway 5
Eden Prairie, MN 55344
Telephone: 612 937-7254
Fax: 612 937-7130
www.eatonhydraulics.com

46 New Lane, Havant
Hampshire PO9 2NB
England
Telephone: (44) 170-548-6451
Fax: (44) 170-548-7110

